

Bipolar Millivolt Input Table

DESCRIPTION

This data sheet applies to the Bipolar Signal Isolator BSI234 when ordered with the following code;

- BSI234-X9X0X3
where the 'X' positions indicate other options defined on the main data sheet.

All specifications and connections are the same as the main data sheet.

Response time Table 1

Table 1	SW1/1
5ms	
500ms	X

Bipolar Millivolt input Table 6

Table 6	SW1					
Input	2	3	4	5	6	7
+/-20mV		X	X	X		
+/-25mV		X	X	X	X	
+/-40mV		X	X			
+/-50mV		X	X		X	
+/-60mV		X		X		
+/-75mV		X		X	X	
+/-100mV		X				X
+/-125mV			X	X	X	
+/-200mV			X			
+/-250mV			X		X	
+/-300mV				X		
+/-500mV					X	

To change ranges

1. Disconnect power unclip housing lid and withdraw unit from housing.
2. Set coding plugs as required.
3. Reassemble unit and connect power.
4. Adjust "Span and "Offs" pots to recalibrate.
5. Change the label information to the new input/output values.

Coding Plug Location Diagram

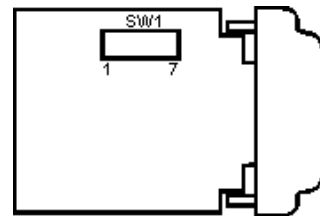

In the interest of development and improvement, A.P.C.S. Pty. Ltd. reserve the right to amend, without notice, details contained in this publication.
A.P.C.S. PTY. LTD. will accept no legal liability for any errors, omissions or amendments.